

400-3000 l  
Volumes

6 bar  
95°C  
Working pressure tank

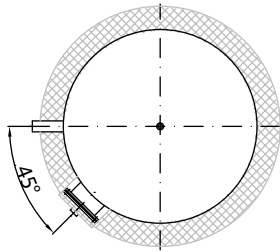

## VTN-3



- H ..... Air vent
- h1 ..... Cold water, drainage
- h2 ..... Return pipe of external heat exchanger
- h3 ..... Supply pipe of external heat exchanger
- h4 ..... Hot water
- h9 ..... Recirculation
- h10-h13 ..... Connecting the control-adjusting and measuring fixtures
- h14 ..... Flange, Ø115mm

V <sub>tank</sub> , l	Dimensions, mm				Mounting dimensions, mm								
	H	ØD1	ØD	Ød	h1	h2	h3	h4	h9	h10	h11	h13	h14
400	1705	800	600	450	75	321	1161	1381	1001	296	856	1271	481
	1/2"				1"				3/4"				
500	1955	800	600	450	75	321	1411	1631	1131	296	956	1521	481
	1/2"				1"				3/4"				
750	2025	950	750	600	75	363	1453	1673	1173	338	998	1563	523
	1/2"				1 1/4"				1"	3/4"			
1000	2060	1050	850	700	75	380	1470	1690	1190	355	1015	1580	540
	1/2"				1 1/4"				1"	3/4"			
1500	2200	1200	1000	850	75	461	1551	1771	1271	436	1096	1661	621
	1/2"				1 1/2"				1 1/4"	3/4"			
2000	2300	1400	1200	1000	75	511	1601	1821	1321	486	1146	1711	671
	1/2"				1 1/2"				1 1/4"	3/4"			
3000	2410	1600	1400	1150	75	566	1656	1876	1376	541	1201	1766	726
	1/2"				1 1/2"				1 1/4"	3/4"			